

TYPE A

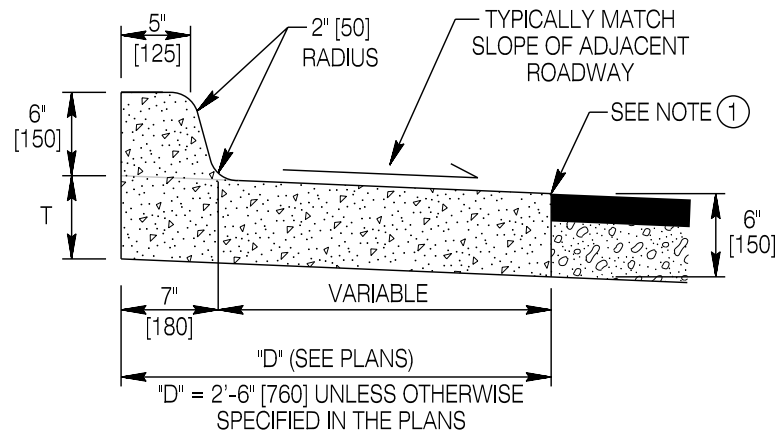

TYPE A SPILLOVER

See note (5)

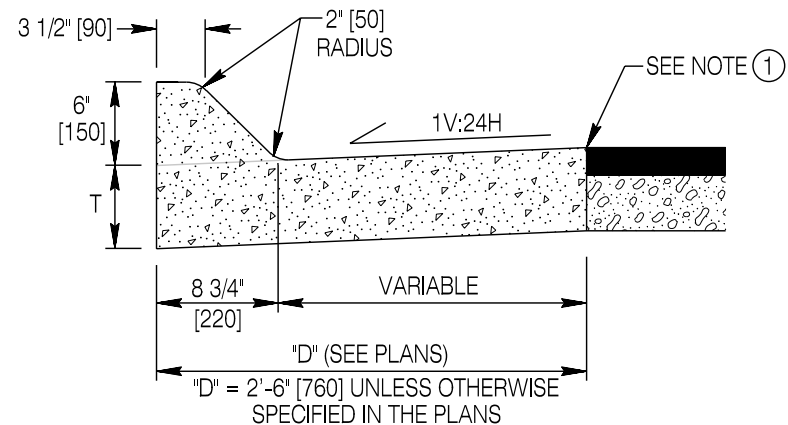

TYPE B

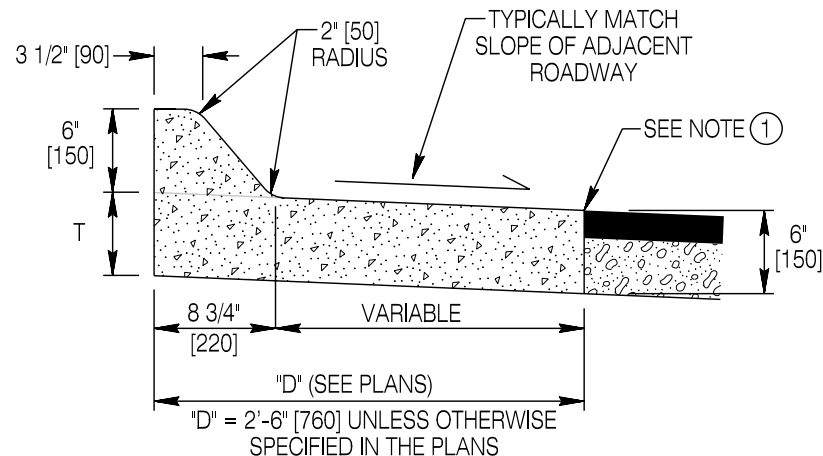

TYPE B SPILLOVER

See note (5)

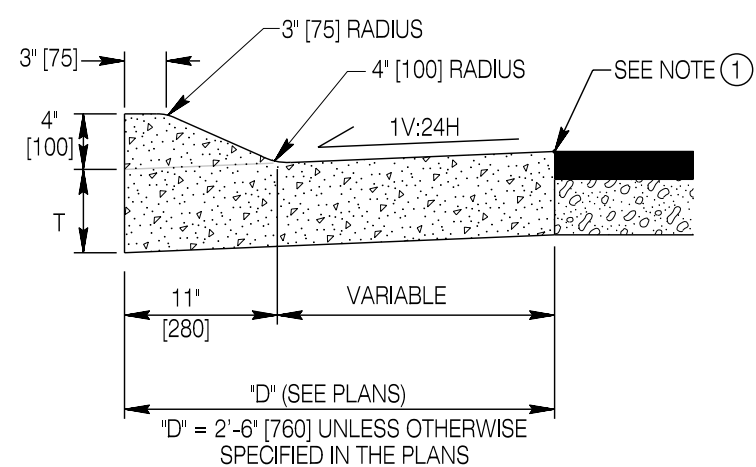

TYPE C

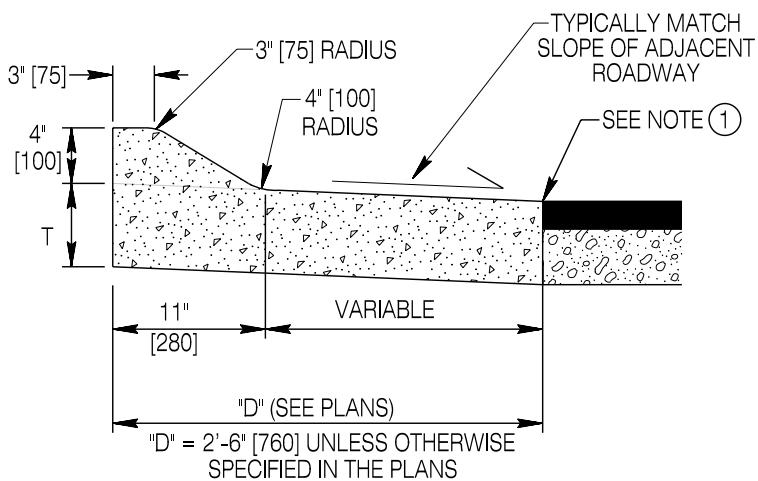

TYPE C SPILLOVER

See note (5)

CURB & GUTTER

GENERAL NOTES

- ① Ensure all pavement surfaces are smoothly tapered and flush at curb ramps to facilitate wheelchair movements.
- ② Ensure sidewalk curb ramps, approaches, and other ADA accessibility features apply to this standard plan. See standard plan for "CONCRETE SIDEWALK AND ADA ACCESSIBILITY" for additional requirements.
- ③ Joints (B), (X) and (Y) are detailed in the standard plan for "CONCRETE PAVEMENT".
- ④ T = Thickness of gutter pan or double gutter.
Unless specified otherwise:
T = 6" [150] where adjacent to plant mix pavement,
T = concrete pavement thickness where adjacent to concrete.
- ⑤ Use spillover curb and gutter only when specified in the plans or as directed by the engineer. Spillover curbs are intended to convey drainage away from the curb such as on the high side of some superelevated highways, the inside of roundabouts, etc.

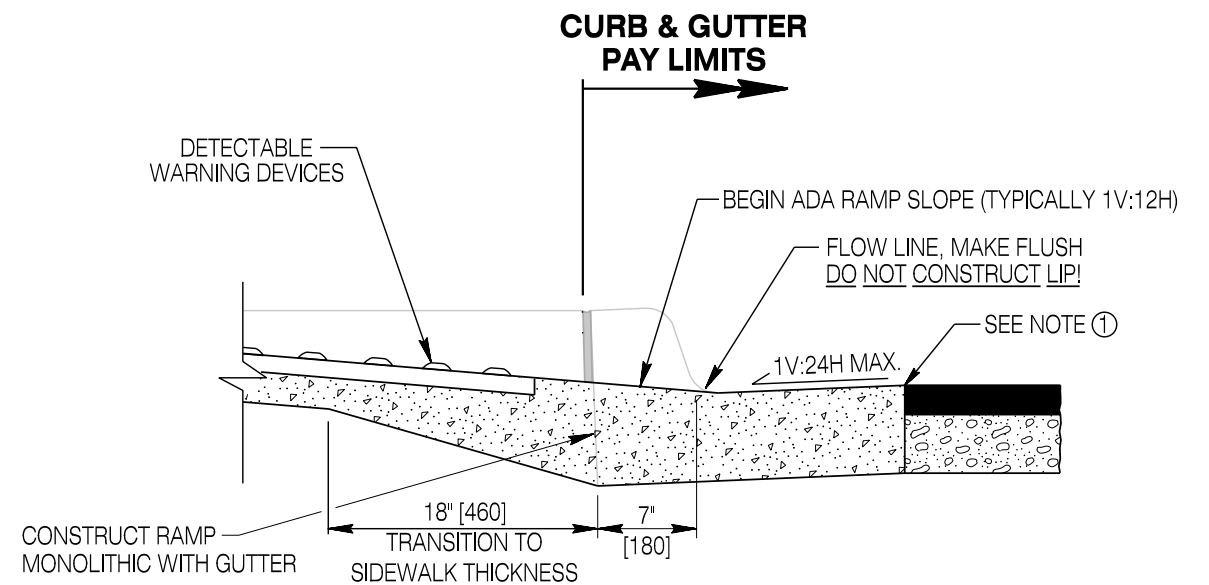

CURB MODIFICATION AT CURB RAMPS

(Type A curb shown in this depiction)

Designed by: WBW
 Drawn by: JK
 Checked by: WBW
 Previous Dwg. No. 609-1A

CURB AND GUTTER DETAILS



WYOMING DEPARTMENT OF TRANSPORTATION

CURB AND GUTTER, DOUBLE GUTTER AND MEDIAN PAVING

STANDARD PLAN

STANDARD PLAN NUMBER

609-1B

SHEET 1 of 3

Issued by: ENGINEERING SERVICES

Date Issued: JANUARY 2012

Note: Units shown in brackets [] are metric and are in millimeters (mm) unless other units are shown.

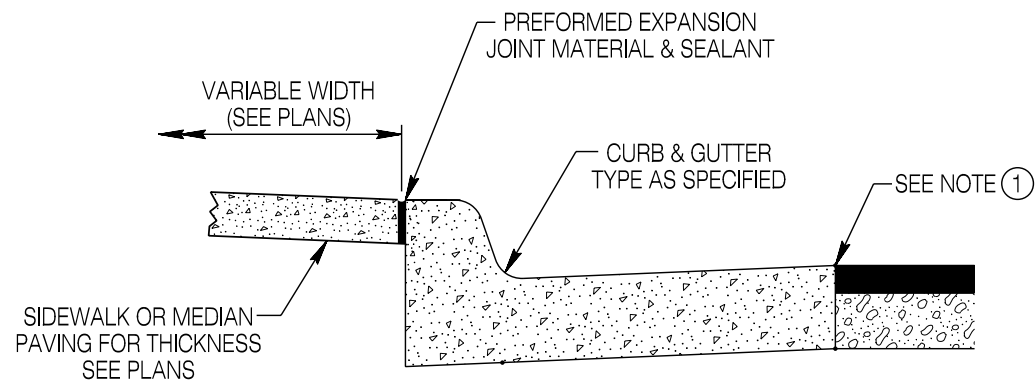

CURB & GUTTER BETWEEN SIDEWALK OR MEDIAN PAVING AND ASPHALT PAVEMENT

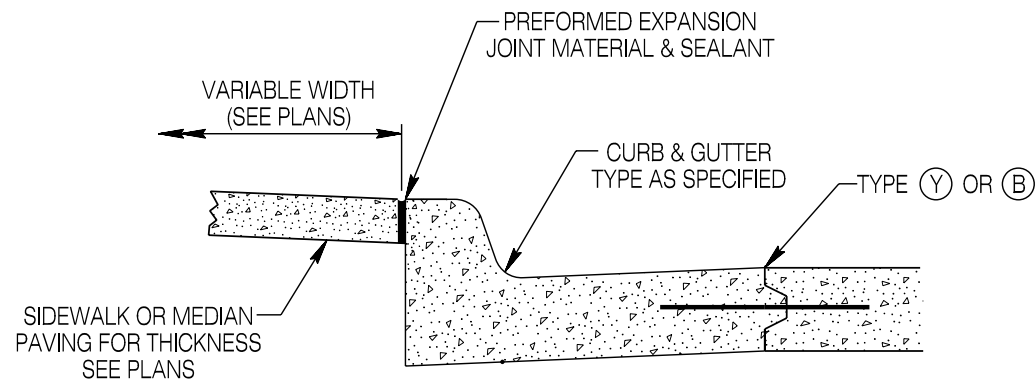

CURB & GUTTER BETWEEN SIDEWALK OR MEDIAN PAVING AND CONCRETE PAVEMENT

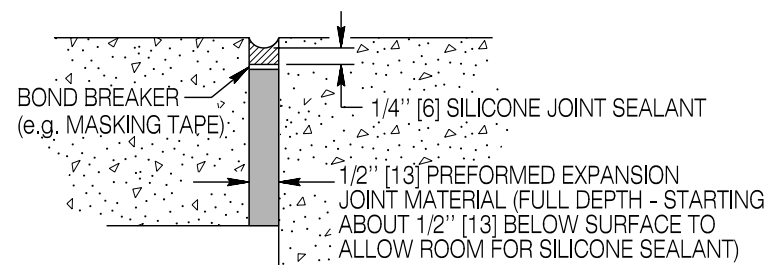

PREFORMED EXPANSION JOINT MATERIAL & SEALANT DETAIL

CURB AND GUTTER JOINT DETAILS

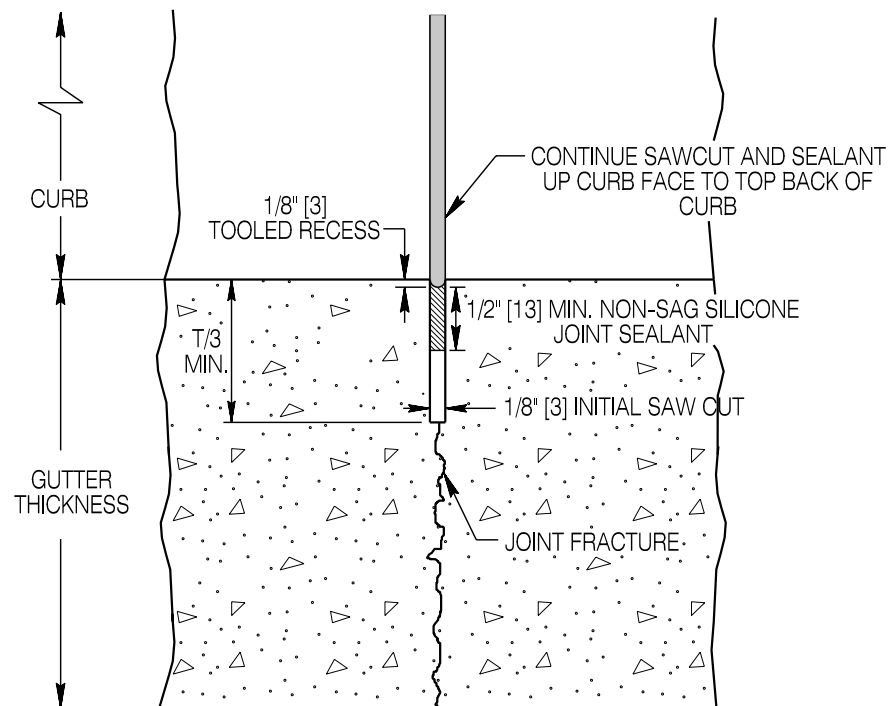

TYPICAL TRANSVERSE CONTRACTION JOINT DETAIL

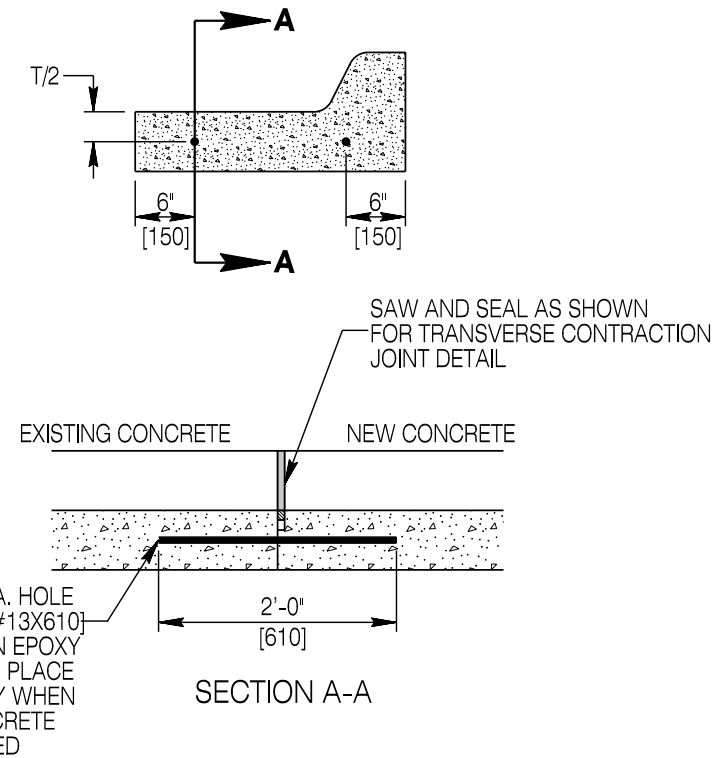

TYPICAL TRANSVERSE CONSTRUCTION JOINT

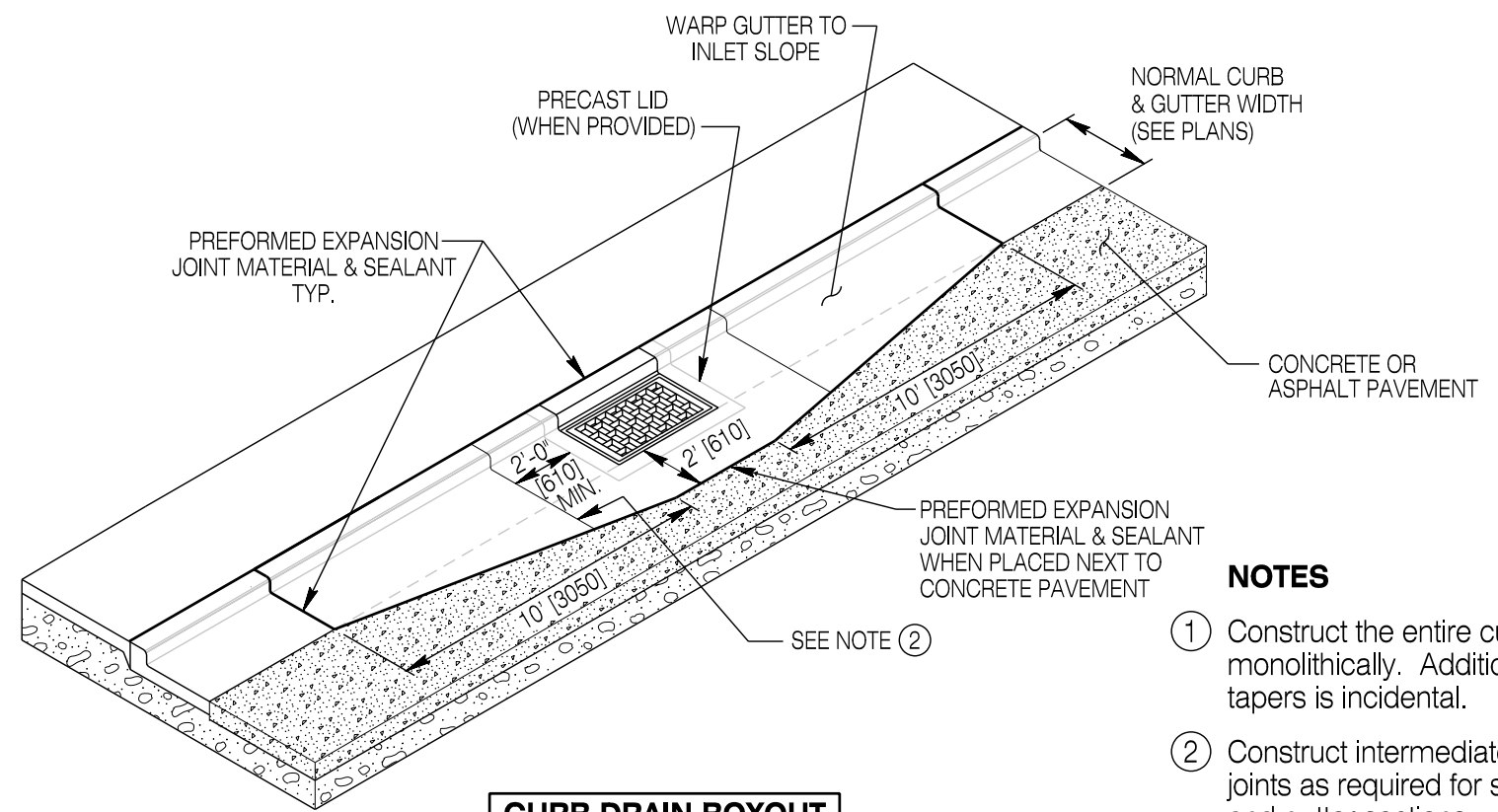

CURB DRAIN BOXOUT

NOTES

- ① Construct the entire curb drain boxout monolithically. Additional concrete for tapers is incidental.
- ② Construct intermediate transverse joints as required for standard curb and gutter sections.

Designed by: WBW
 Drawn by: JK
 Checked by: WBW
 Previous Dwg. No. 609-1A

CURB AND GUTTER AND DOUBLE GUTTER JOINT DETAILS AND CURB DRAIN BOXOUT DETAILS

Note: Units shown in brackets [] are metric and are in millimeters (mm) unless other units are shown.



WYOMING DEPARTMENT OF TRANSPORTATION



CURB AND GUTTER, DOUBLE GUTTER AND MEDIAN PAVING

STANDARD PLAN

STANDARD PLAN NUMBER

609-1B

SHEET 2 of 3

Issued by: ENGINEERING SERVICES

Date Issued: JANUARY 2012

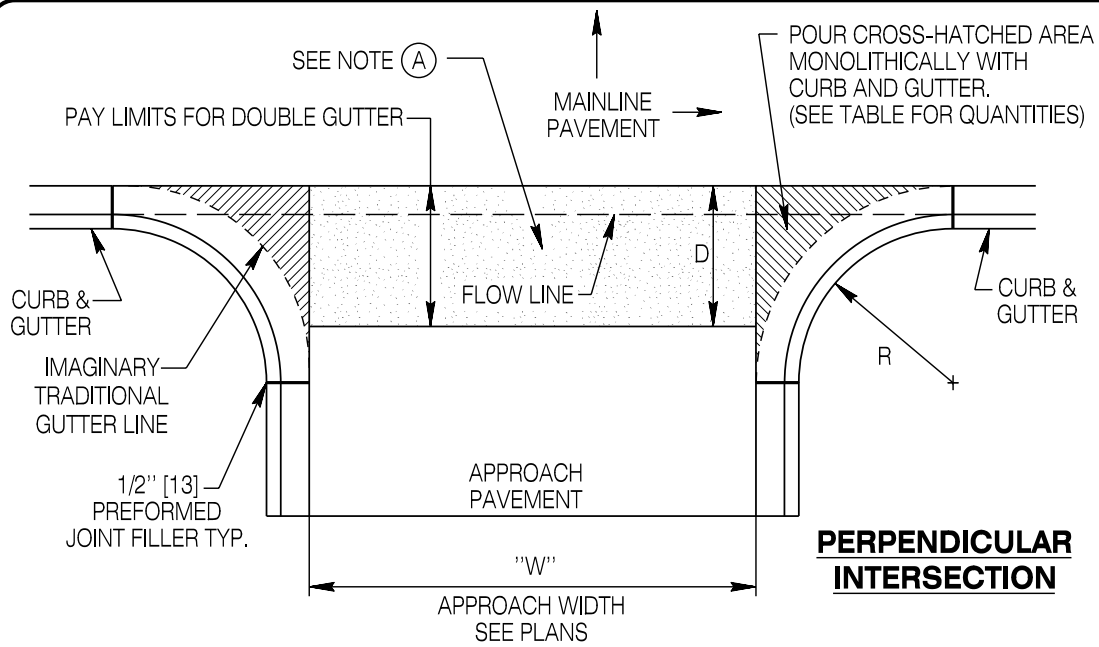

Square off gutter pan creating an apron as shown. The added concrete quantities will be incidental to the pay item, Curb & Gutter.

ESTIMATED ADDITIONAL CONCRETE QUANTITIES FOR CROSS-HATCHED AREA FOR PERPENDICULAR INTERSECTIONS ONLY *							
RADIUS		CONCRETE		RADIUS		CONCRETE	
Ft	m	CY	m ³	Ft	m	CY	m ³
5	1.5	0.2	0.15	25	7.6	3.0	2.29
10	3.0	0.6	0.46	30	9.1	4.2	3.21
12	3.7	0.8	0.61	40	12	7.2	5.50
15	4.6	1.2	0.92	45	13.7	9.0	6.86
20	6.1	2.0	1.53	50	15.2	11.0	8.37

*Approximate additional concrete quantity for one square out. Tables values are based on a perpendicular intersection, 6 in. [150] thick gutter and on "D"=2 ft-6in. [760]. Table provided for estimating purposes only.

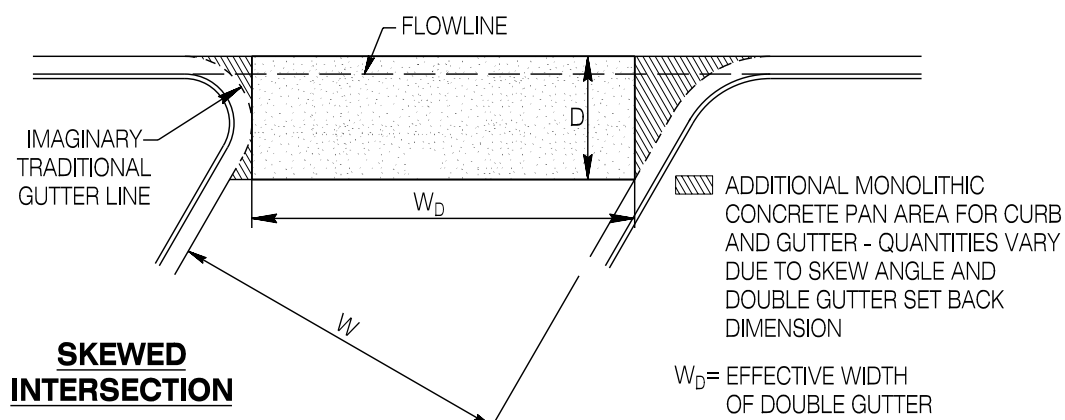

CURB AND GUTTER AND DOUBLE GUTTER REQUIREMENTS AT INTERSECTIONS

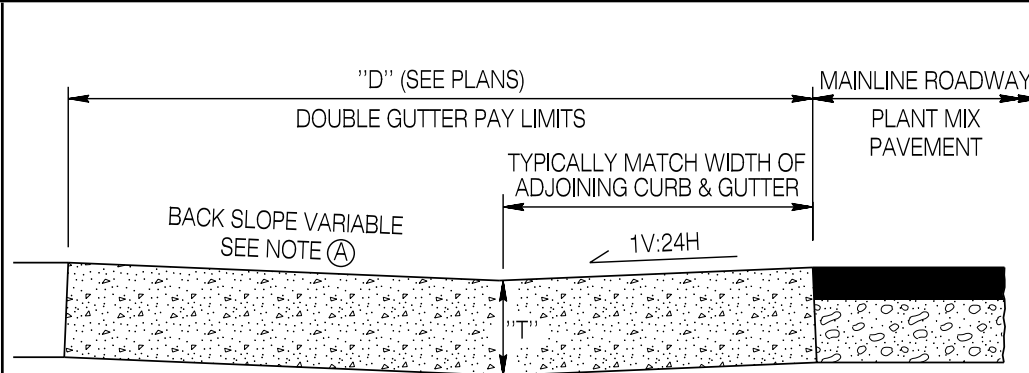

DOUBLE GUTTER ADJACENT TO MAINLINE PLANT MIX PAVEMENT

T = See note ④, General Notes, Sheet 1.

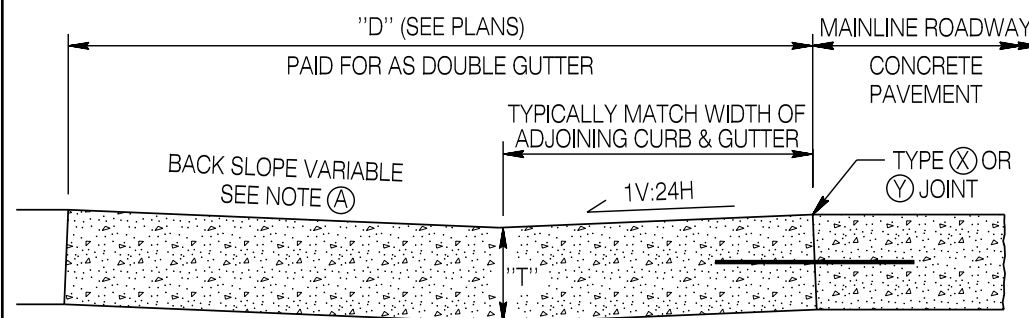

DOUBLE GUTTER ADJACENT TO MAINLINE CONCRETE PAVEMENT

For Double Gutter next to concrete pavement, match concrete pavement contraction joint spacing.

DOUBLE GUTTER REQUIREMENTS

T = See note ④, General Notes, Sheet 1

- ① Ensure the backslope for double gutter is 1V:48H or flatter when located in the path of a pedestrian crossing to meet ADA requirements. Otherwise, use a slope as directed by the Engineer.
- ② See sidewalk standard plan for further requirements for double gutter for (driveway) approaches located within city blocks.

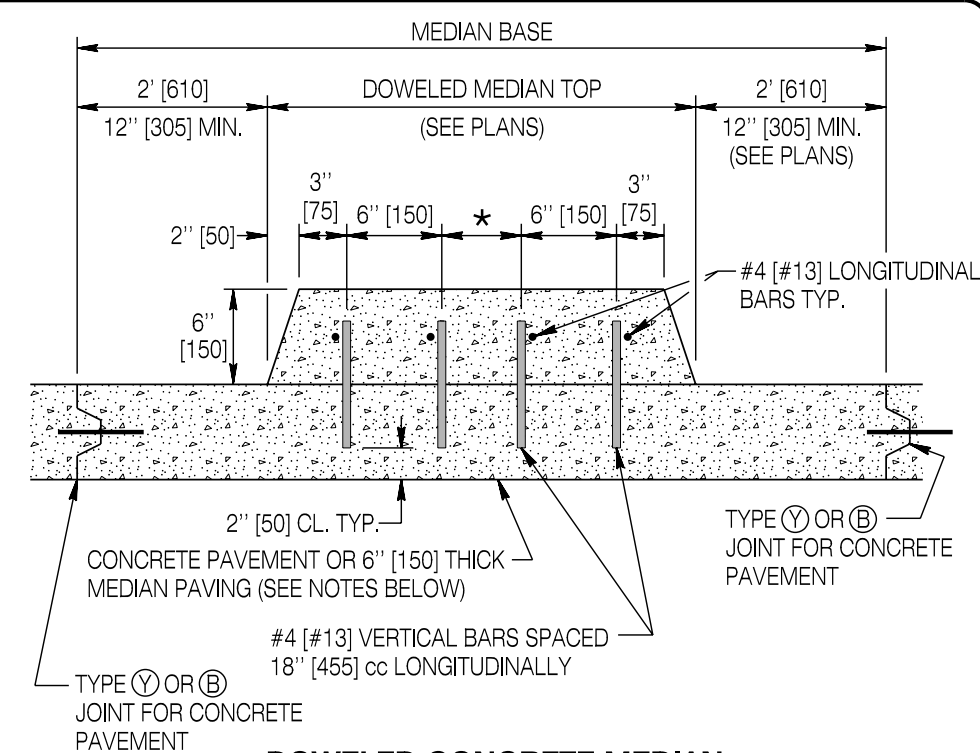

DOWELED CONCRETE MEDIAN

* For median top widths wider than 4 ft [1.2 m], use additional vertical and longitudinal bars. Ensure bars are added and spaced no greater than 18 in [455] cc in the lateral and longitudinal direction.

If doweled concrete median is located in an area of concrete pavement, use concrete pavement as base. Dowel top to concrete pavement, measure and pay the base as concrete pavement. Measure and pay the doweled median top as median paving.

If doweled concrete median is located adjacent to plant mix pavement, measure and pay the base of concrete median as median paving. Pay the doweled median top as an additional area of median paving.

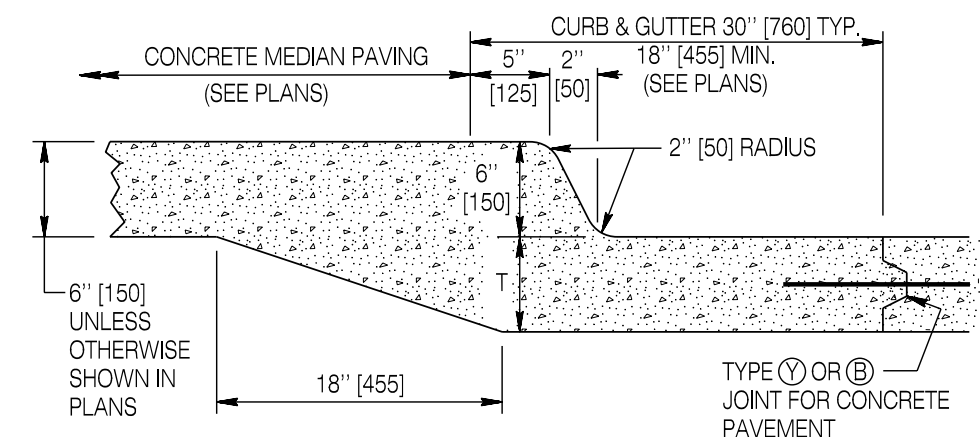

INTEGRAL CURB & MEDIAN PAVING

MEDIAN PAVING DETAILS

DOUBLE GUTTER DETAILS

Designed by: WBW
 Drawn by: JK
 Checked by: WBW
 Previous Dwg. No. 609-1A

Note: Units shown in brackets [] are metric and are in millimeters (mm) unless other units are shown.



**CURB AND GUTTER
 DOUBLE GUTTER AND MEDIAN PAVING
 STANDARD PLAN**

STANDARD PLAN NUMBER
609-1B
 SHEET 3 of 3
 Issued by: ENGINEERING SERVICES
 Date Issued: JANUARY 2012